

CETTIG

Surface-mounted Downlight

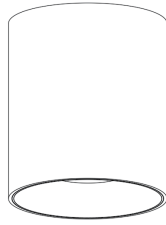

To secure safety, a qualified electrician is required to install/remove the luminaire, in according with IEEE regulation and installation instructions.



CAUTION: Electric Shock.....



Don't stare at the operating light source.....



CAUTION: the luminaire must not be disposed of with household waste.....

Model	Power	Products Size
8961LED	10W/15W/20W	φ 96xH125mm
81251LED	25W/30W/40W	φ 125xH150mm
81801LED	50W/60W/70W/80W	φ 180xH210mm

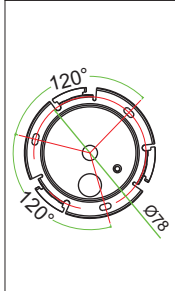

8961LED

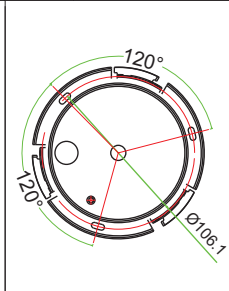

81251LED

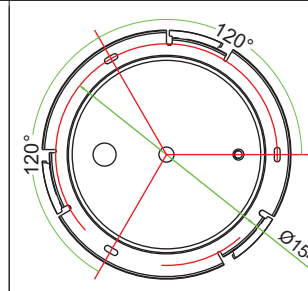

81801LED

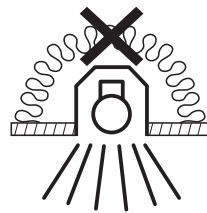

Luminaire not suitable for covering with thermally insulating material.

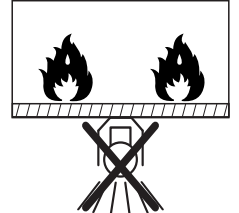

Luminaire can't recessed mounted into flammable material.

Installation:

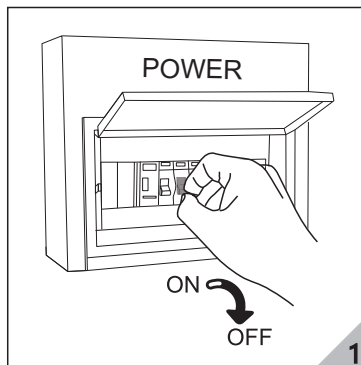

1

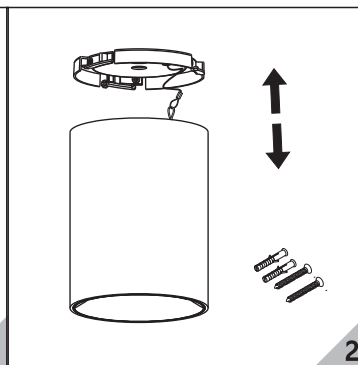

2

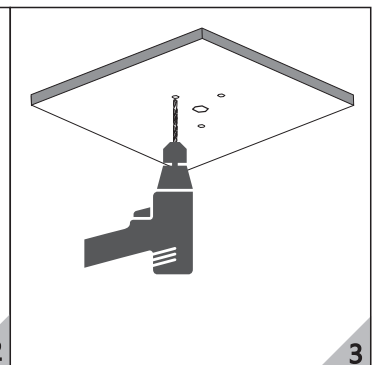

3

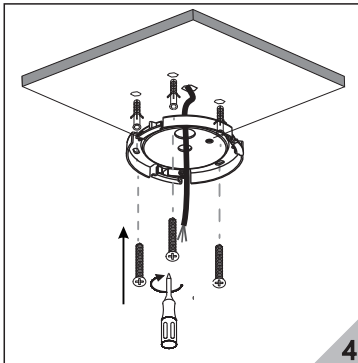

4

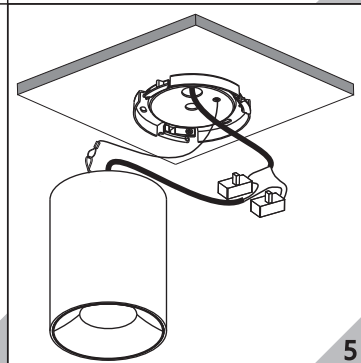

5

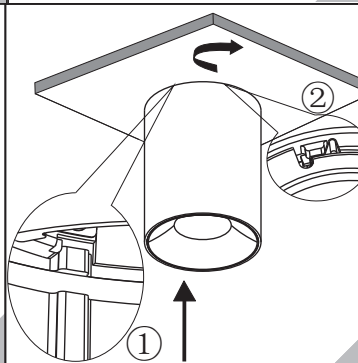

6

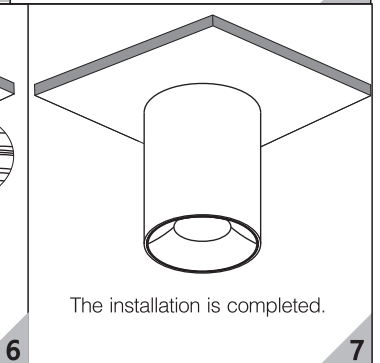

7

The installation is completed.

Maintenance:

Pull out the fixture down from the ceiling.

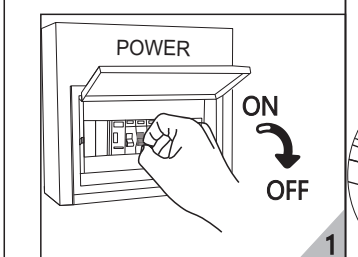

1

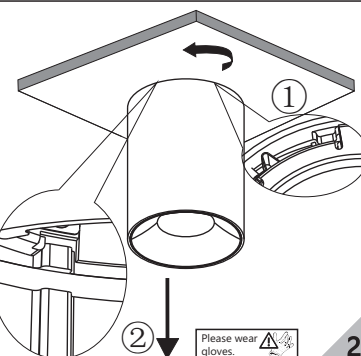

2

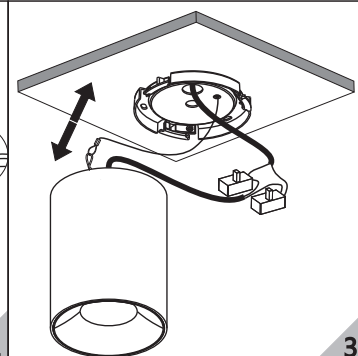

3

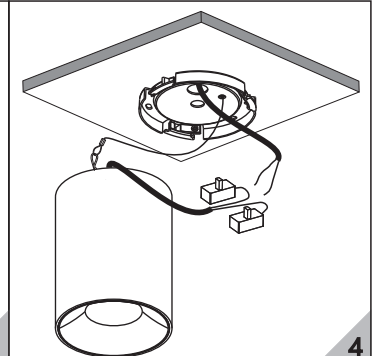

4